

SPECIFICATION FOR APPROVAL

NR8040C Series

Rev.No.	A
Page	1

I . CONFIGURATION&DIMENSIONS:

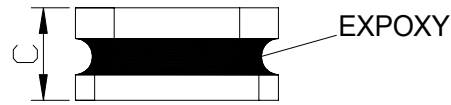
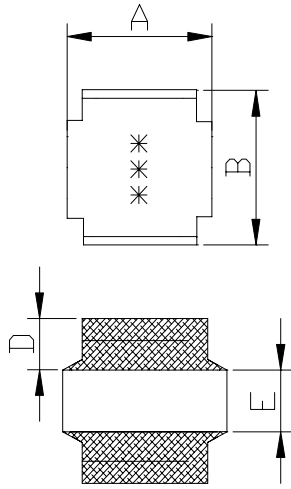

A:8.0±0.2 mm

B:8.0±0.2 mm

C:4.0max mm

D:2.0ref mm

E:2.0ref mm

PART NO.	Ls	DCR (Ω)	Isat	Irms	SRF (MHz)	TEST FREQ.
	(uH)0A	±30%	(A)	(A)	min	(Hz)
<input type="checkbox"/> NR8040C-1R0N-R-S	1.0	0.008	9.85	6.30	89	100K/1V
<input type="checkbox"/> NR8040C-1R5N-R-S	1.5	0.010	8.15	5.65	67	100K/1V
<input type="checkbox"/> NR8040C-2R2N-R-S	2.2	0.012	7.10	5.15	41	100K/1V
<input type="checkbox"/> NR8040C-3R3N-R-S	3.3	0.017	6.50	4.40	27	100K/1V
<input type="checkbox"/> NR8040C-4R7N-R-S	4.7	0.019	5.90	4.10	24	100K/1V
<input type="checkbox"/> NR8040C-5R1N-R-S	5.1	0.019	4.70	4.05	22	100K/1V
<input type="checkbox"/> NR8040C-6R8M-R-S	6.8	0.024	4.55	3.60	20	100K/1V
<input type="checkbox"/> NR8040C-8R2M-R-S	8.2	0.026	4.20	3.45	17	100K/1V
<input type="checkbox"/> NR8040C-100M-R-S	10.0	0.029	3.60	3.30	15	100K/1V
<input type="checkbox"/> NR8040C-150M-R-S	15.0	0.047	2.95	2.60	12	100K/1V
<input type="checkbox"/> NR8040C-220M-R-S	22.0	0.069	2.40	2.10	9.5	100K/1V
<input type="checkbox"/> NR8040C-330M-R-S	33.0	0.097	2.05	1.80	7.8	100K/1V
<input type="checkbox"/> NR8040C-470M-R-S	47.0	0.136	1.75	1.55	6.4	100K/1V
<input type="checkbox"/> NR8040C-680M-R-S	68.0	0.196	1.45	1.25	4.9	100K/1V
<input type="checkbox"/> NR8040C-101M-R-S	100.0	0.290	1.15	1.00	4.2	100K/1V
<input type="checkbox"/> NR8040C-221M-R-S	220.0	0.599	0.85	0.80	3.5	100K/1V
<input type="checkbox"/> NR8040C-331M-R-S	330	0.889	0.68	0.64	2.8	100K/1V