

SPECIFICATION FOR APPROVAL

NR4030C Series

Rev.No.	A
Page	1

I .CONFIGURATION&DIMENSIONS:

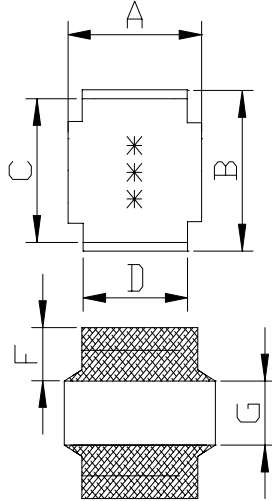

A:4.0±0.2 mm
B:4.0±0.2 mm
C:3.7±0.2 mm
D:3.2±0.2 mm
E:3.0 MAX mm
F:1.0 REF mm
G:2.0 REF mm

PART NO.	Ls	DCR (Ω)	Isat	Irms	SRF (MHz)	TEST FREQ.
	(uH)0A	±30%	(A)	(A)	min	(Hz)
<input type="checkbox"/> NR4030C-1R0N-R-S	1.0	0.014	5.26	4.15	70	100K/1V
<input type="checkbox"/> NR4030C-1R5N-R-S	1.5	0.020	4.84	3.34	62	100K/1V
<input type="checkbox"/> NR4030C-2R2N-R-S	2.2	0.030	4.40	2.95	52	100K/1V
<input type="checkbox"/> NR4030C-3R3M-R-S	3.3	0.040	3.30	2.40	38	100K/1V
<input type="checkbox"/> NR4030C-4R7M-R-S	4.7	0.060	2.90	2.00	31	100K/1V
<input type="checkbox"/> NR4030C-6R8M-R-S	6.8	0.090	2.75	1.60	24	100K/1V
<input type="checkbox"/> NR4030C-100M-R-S	10.0	0.100	1.95	1.50	21	100K/1V
<input type="checkbox"/> NR4030C-150M-R-S	15.0	0.190	1.65	1.11	16	100K/1V
<input type="checkbox"/> NR4030C-220M-R-S	22.0	0.225	1.30	1.00	10	100K/1V
<input type="checkbox"/> NR4030C-330M-R-S	33.0	0.330	1.10	0.48	10	100K/1V
<input type="checkbox"/> NR4030C-390M-R-S	39.0	0.435	1.03	0.73	10	100K/1V
<input type="checkbox"/> NR4030C-470M-R-S	47.0	0.445	0.95	0.72	8.4	100K/1V
<input type="checkbox"/> NR4030C-560M-R-S	56.0	0.555	0.85	0.65	8.4	100K/1V
<input type="checkbox"/> NR4030C-680M-R-S	68.0	0.868	0.72	0.52	7.0	100K/1V
<input type="checkbox"/> NR4030C-101M-R-S	100	1.150	0.60	0.45	5.6	100K/1V