

SMD Power Inductors JHE322520 Series

JHE322520 series consists of miniature chip inductors wire wound on a special ferrite core

1. High Q value at high frequencies and low DC resistance
2. Wide inductance range from 1.0 to 2200 micro H

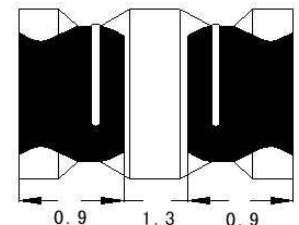
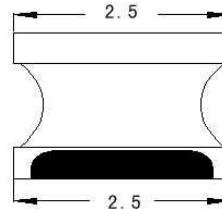
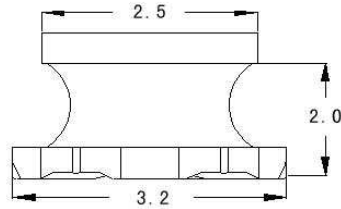

UNIT: mm

PART NO	L(uH)	DCR max (mΩ)	IDC max (A)	TEST FREQ. (Hz)
JHE 322520-R27N	0.27	250	0.6	1M/0.25V
JHE322520-R39N	0.39	250	0.53	1M/0.25V
JHE322520-R56N	0.56	250	0.53	1M/0.25V
JHE322520-R68N	0.68	250	0.47	1M/0.25V
JHE322520-R82N	0.82	250	0.45	1M/0.25V
JHE322520-1R0N	1	500	0.445	1M/0.25V
JHE322520-1R2N	1.2	600	0.425	1M/0.25V
JHE322520-1R5N	1.5	600	0.4	1M/0.25V
JHE322520-1R8N	1.8	700	0.39	1M/0.25V
JHE322520-2R2N	2.2	800	0.37	1M/0.25V
JHE322520-2R7N	2.7	900	0.32	1M/0.25V
JHE322520-3R3N	3.3	1000	0.3	1M/0.25V
JHE322520-3R9N	3.9	1100	0.29	1M/0.25V
JHE322520-4R7N	4.7	1200	0.27	1M/0.25V
JHE322520-5R6N	5.6	1300	0.25	1M/0.25V
JHE322520-6R8N	6.8	1500	0.24	1M/0.25V
JHE322520-8R2N	8.2	1600	0.225	1M/0.25V
JHE322520-100K	10	1800	0.19	1M/0.25V
JHE322520-120K	12	2000	0.18	1M/0.25V
JHE322520-150K	15	2200	0.17	1M/0.25V
JHE322520-180K	18	2500	0.165	1M/0.25V
JHE322520-220M	22	2800	0.15	1M/0.25V
JHE322520-270K	27	3100	0.125	1M/0.25V
JHE322520-330K	33	3500	0.115	1M/0.25V
JHE322520-390K	39	3900	0.11	1M/0.25V
JHE322520-470K	47	4300	0.1	1M/0.25V
JHE322520-560K	56	4900	0.085	1M/0.25V
JHE322520-680K	68	5500	0.08	1M/0.25V
JHE322520-820K	82	6200	0.08	1M/0.25V
JHE322520-101K	100	7000	0.08	1M/0.25V
JHE322520-121K	120	8000	0.075	1M/0.25V
JHE322520-151K	150	9300	0.07	1M/0.25V
JHE322520-181K	180	10200	0.065	1M/0.25V
JHE322520-221K	220	11800	0.065	1M/0.25V
JHE322520-271K	270	12500	0.065	1M/0.25V
JHE322520-331K	330	13000	0.065	1M/0.25V
JHE322520-391K	390	22000	0.065	1M/0.25V
JHE322520-471K	470	25000	0.05	1M/0.25V
JHE322520-561K	560	28000	0.045	1M/0.25V

1. Inductance tested at 100KHz, 0.1V;
2. Inductance drop = 10% typ. at rated Isat;
3. $\Delta T = 40^\circ\text{C}$ rise typ. at Irms;
4. Operating temperature range -40°C to $+125^\circ\text{C}$;
5. Electrical specifications at $+25^\circ\text{C}$;

Packing :
Reel size: 8 mm
Quantity: 2000PCS/Reel

Special inquiries besides the above common used types can be met on your requirement.